

Wellborn 2013 Design Contest Entry

Entry ID: 100419

#	Customer	Entry	Designer	Photographer
1	0001003608 YORKSHIRE STONE, INC.	100419	Crystal Kennedy crystal@pnwcab.com 503-652-9354	Shannon Butler photoartportraits@gmail.com 503-891-9354 Owner: Entrant
Project		Project Details		Project Date
Butler s Pantry		Other Rooms Type: Remodel Size:55 x145		01/2012
Series	Door Style	Species		Finish
Select	Prairie	Maple		Divinity
Description				
<p>This is the 3rd project we were asked to do for this couple. We had helped them with their kitchen – and now their pantry was in dire need of help. It had become a catch all for various items that didn't quite have a place in the main kitchen and consequently had become almost useless. We were tasked with cleaning out and organizing the space, adding storage and function to this underutilized space</p> <p>Problems/Challenges:</p> <ul style="list-style-type: none"> -Very cluttered, everything was shoved into place and very visible -They wanted this to be an area that could house a microwave and second oven for overflow cooking during the holidays -Wanted an area to house his espresso maker and accoutrement since it didn't fit in the kitchen -Wanted a sink for quick access to water and an extra place to clean up -Wanted a space for bottle storage up and out of the way -Lacked any kind of countertop space at all so no real work could be done in the space -Didn't want it to look too dark or heavy -Their existing door swung into the pantry, making it hard to maneuver inside <p>Solutions:</p> <ul style="list-style-type: none"> -Added enclosed cabinet storage with Wellborn's Prairie Maple Painted in the Divinity finish. Giving the pantry a bright feel overall -Bookcases that sit on the countertop provide open storage for a tight space. Clear mason jars provide an attractive and functional way to store them -A sink was added at the end of the pantry under the window, right next to the espresso and coffee makers -An unused chimney was removed and recessed in the space we installed a new convection microwave and second oven. Giving them plenty of extra cook space and getting it out of the way and off the countertop -A shelf was added running along the kitchen wall to house their bottle storage where it won't take up space used by everyday items -Added granite that matched their kitchen for a cohesive look -Changed the door to a pocket door and added glass for a more open look and more light 				

The pantry now feels like a functional extension of their kitchen and matches the look of their beautiful home as well!

GARAGE

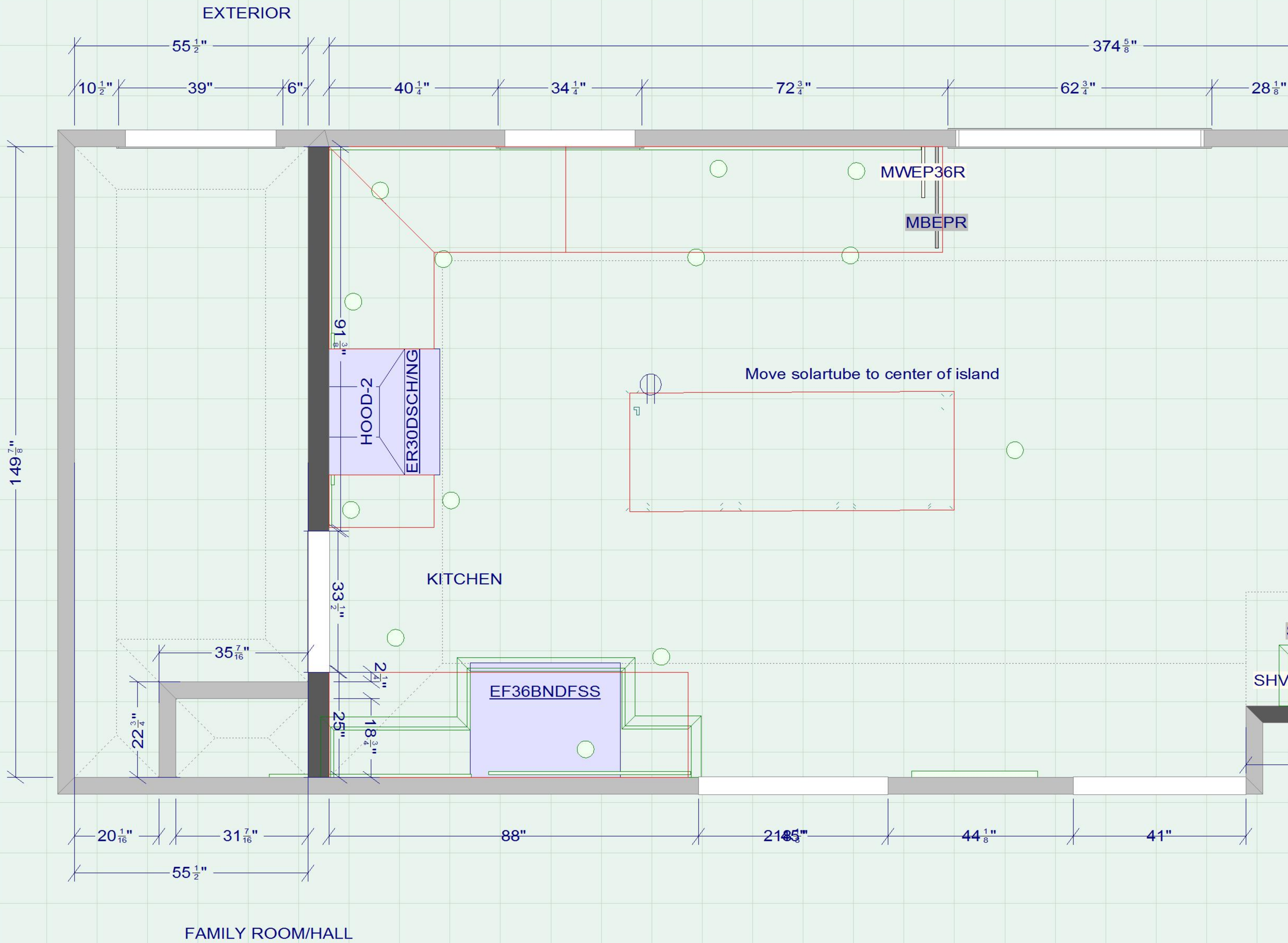





GIORDANO

GIORDANO

10:49

12:45

BANFI
CHIANTI CLASSICO
2005





EXTERIOR

GARAGE

KITCHEN

FAMILY ROOM/HALL

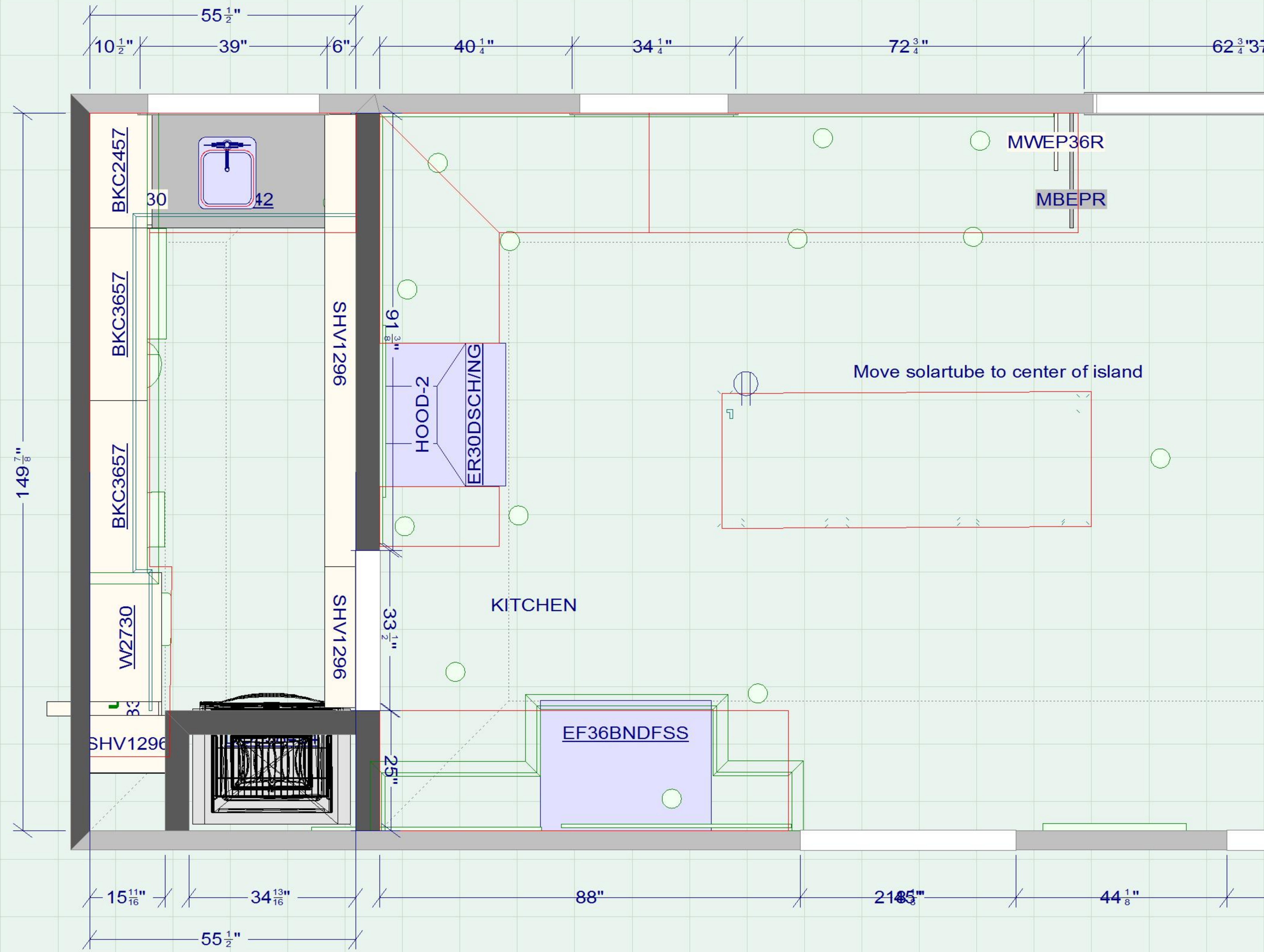















RECIPES TREASURY
TODD WILBUR
How to Cook Everything
MARTHA STEWART
THE BARBECUE BIBLE
GRILL

PRACTICAL JAPANESE COOKING EASY AND ELEGANT
American Cooking

MORE BEST RECIPES
THE NEW BEST RECIPE FROM THE EDITORS OF FOOD52 ILLUSTRATED
THE BEST MAKE-AHEAD RECIPES
THE BEST SLOW & EASY RECIPES
BEST AMERICAN SIDE DISHES FROM THE EDITORS OF FOOD52 ILLUSTRATED
THE BEST OF AMERICA'S TEST KITCHEN
KOTZEN MOOSEWOOD COOKBOOK
Julia Child & Company
Martha Stewart's Healthy Quick Cook
MARTHA STEWART'S QUICK COOK METHODS
FANNIE FARMER COOKBOOK
JOY OF COOKING

MARTHA STEWART LIVING COOKBOOK
THE NEW BASICS COOKBOOK
Mastering the Art of French Cooking Julia Child
THE AMERICA'S TEST KITCHEN Family Baking Book
Betty Crocker's COOKBOOK
THE AMERICA'S TEST KITCHEN Family Cookbook

OLNEY & FLOYD
SUGAR CORN



